

Screw plugs (cable gland)  
 1x M25x1,5  
 1x M32x1,5  
 1x M40x1,5

1046

620

184

63

Ø100 f8 (for F14)

M36x3 (for F14)

20<sup>1)</sup> 206 (276<sup>2)</sup> / 296<sup>3)</sup> 160

160

275

Position Failsafe  
 Travel max. 100mm

Ø320

Ø70 f8 (for F10)

3

159

A

A

M20x1,5 (for F10)

A-A (1:8)

Output flange:  
 F10+F14 acc. DIN5210

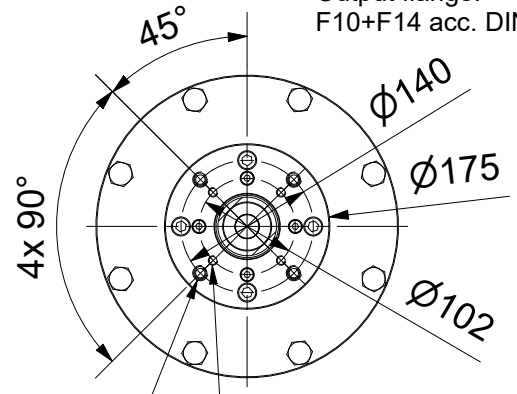

4x M10 -20deep  
 4x M16 - 23deep

1) Space required for removing cover  
 2) for ex terminal box with bus connection "DP"  
 3) for 3 phase version "SDC480"

**SCHIEBEL**

Dimensions

All dimensions in mm

**Actusafe CM06FS100.30**

Type: with handwheel, retracting, F10+F14  
 travel max. 100mm, force 30kN

M-CM06FS100\_30-4-1E

	Dated	Name
drawn	27.09.2017	H.Mayer
checked		

